

Auto DeNesting of Plastic Crates Nigrelli Plastic Crate DeNest

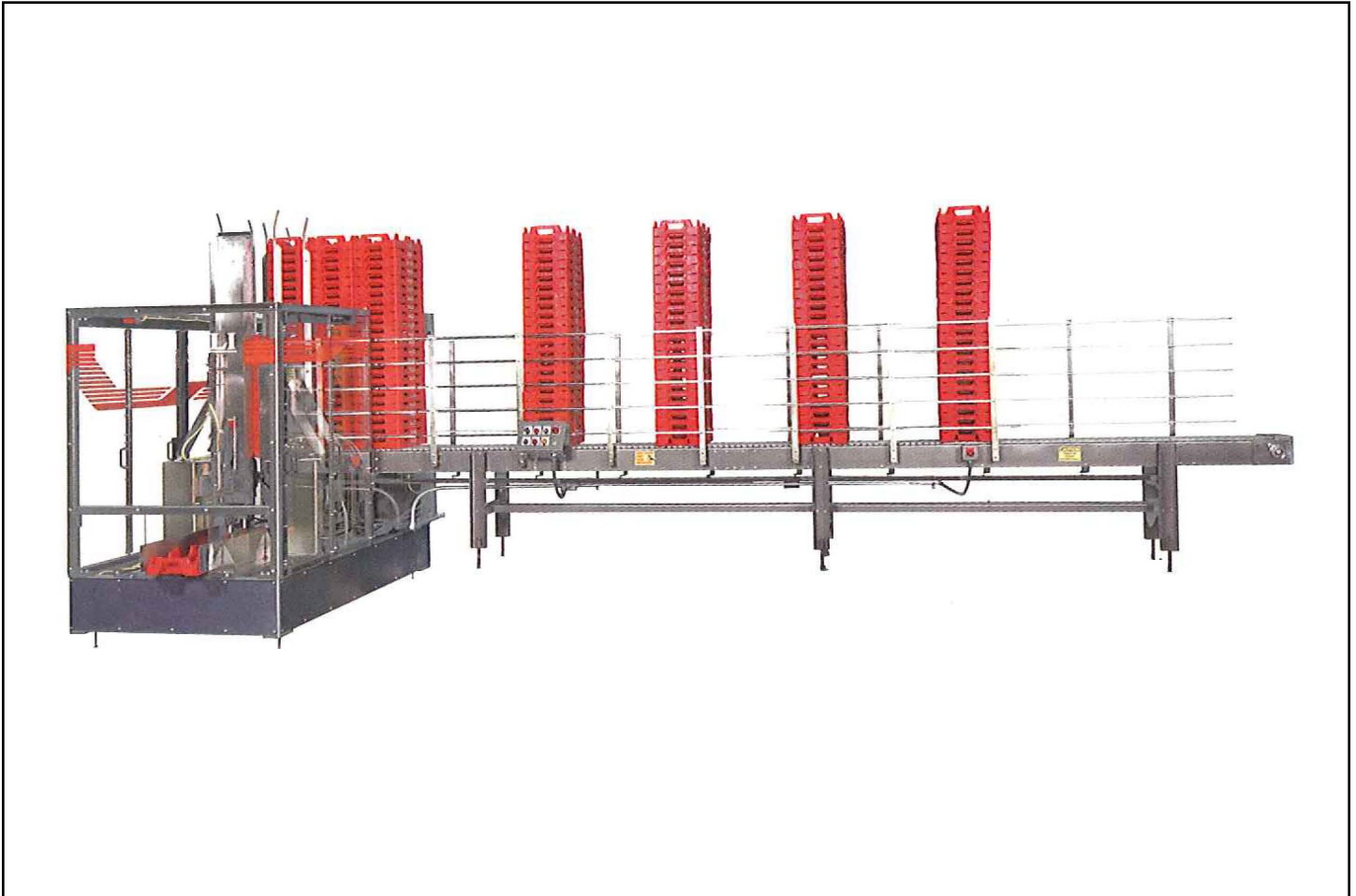

Key Features

- Low, medium or high speed operation
- Right, left hand and in-line systems
- Tool-less changeover - 12oz through 3 liter crates
- Ergonomical - no bending or heavy lifting
- System may be integrated with Thiele Tray Packers
- Allen-Bradley Logix Series PLC
- Mild steel construction painted with Steel-It epoxy paint
- System may be further automated at later date
- Full height guarding access doors with safety locks
- Low hopper detection

Auto DeNesting of Plastic Crates

Nigrelli Plastic Crate DeNest

The Nigrelli Plastic Crate DeNest System is available as an in-line or 90 degree unit with 10, 20, or 30 feet of crate column accumulation conveyor. The system consists of crate feed accumulation conveyor and a DeNesting auto feed unit with crate magazine and power tray discharge. Column stacks of plastic crates are manually placed on the accumulation conveyor; stacks are automatically indexed to the DeNest magazine. The magazine lowers columns of crates into the DeNest unit; the bottom crate is separated from the above column and exits the unit onto the takeaway conveyor. Production speed capacity to 60 crates per minute depending upon crate style.

Nigrelli Plastic Crate Denest II meets the industry demand for tool-less changeover. An operator can complete crate style changeovers, 12 oz. through 3 liter, in less than five minutes utilizing our positive calibrated positioning feature. Full height guarding ensures operator protection with easy access for maintenance, lubrication and parts replacement. The new improved DeNest II increases production speed capacity to 80 crates per minute depending on crate style.

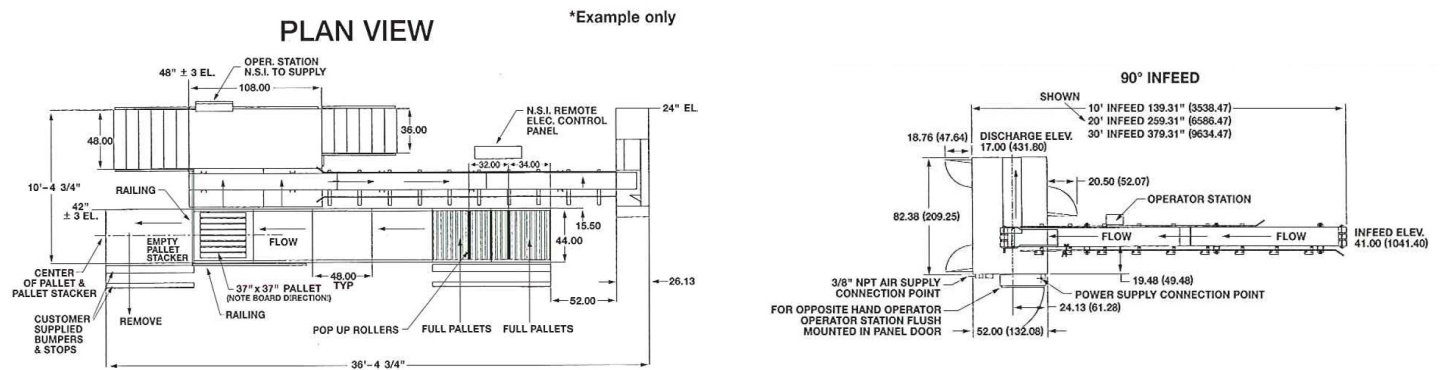

All sales are subject to our prevailing terms and conditions. Illustrations and specifications are subject to change without notice. Machines shown without guards are for illustrative purposes only. Guards are supplied and must be in place before operation.