



Intermittent Motion Wraparound Casepacker FlexiPro Casepacker



Key Features

- Speeds up to 20 cases per minute
- Walk-in area for improved access
- Low profile magazine for easier loading
- Allen-Bradley PanelView HMI with diagnostic alarms
- Nordson hot melt glue system
- Allen-Bradley Logix series PLC
- Inside manufacturer's joint

Intermittent Motion Wraparound Casepacker

FlexiPro Casepacker

Thiele's FlexiPro Wraparound Casepacker is a fully automatic case packaging system designed to end-load a variety of products into wraparound cases. When paired with a Thiele loader and infeed system, the FlexiPro automatically feeds a corrugated blank, erects it, positions the case for loading, and closes and seals the flaps in preparation for palletizing.

Designed for quiet, low-maintenance operation, the FlexiPro features a Venturi vacuum system that ensures positive placement of the wraparound blank.

Mechanical case feeding of this four-station casepacker guarantees positive control of the case throughout the loading, flap folding, and sealing processes. Additionally, although the FlexiPro is designed for maximum versatility, no change parts are required in the case handling area of the system.

Thiele offers a wide variety of loader, accumulation, and infeed solutions for any case packaging application.

Optional Features

- Servo main drive
- Low level case detection
- Beacon light to indicate traypacker operation
- Open flap detection
- Additional magazine length
- Ethernet interface
- UL-listed electrical enclosure
- Digital indicators and calibrated scales

Specifications		
Speed		
Up to 20 trays per minute; final speed dependent on product and product orientation		
Tray Size Range	Minimum	Maximum
Length	8"	15"
Height*	5"	12"
Width	8"	20"
Electrical Requirements		
Incoming Voltage	240/480 volts, 3 phase, 60 Hz	
Control Voltage	24 VDC	
Hot Melt Circuit	240 volt, 60 hertz, 1 to 3 phase (optional transformer available if incoming voltage is other than 240)	
Current Draw	Dependent on loader	
Air Requirements		
Operating Pressure	80 psi	
Line Pressure	90 psi	
Maximum Free Air Consumption	1.24 cu ft per cycle	
Hot Melt Air Pressure	20 to 60 psi	

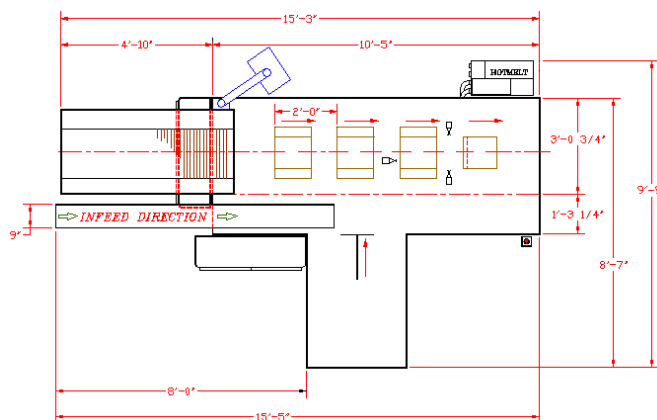

All sales are subject to our prevailing terms and conditions. Illustrations and specifications are subject to change without notice. Machines shown without guards are for illustrative purposes only. Guards are supplied and must be in place before operation.